

R1305?FKS

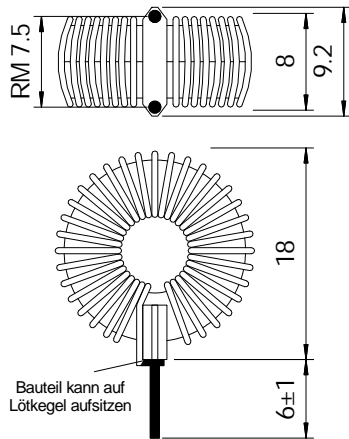

R1305?S11

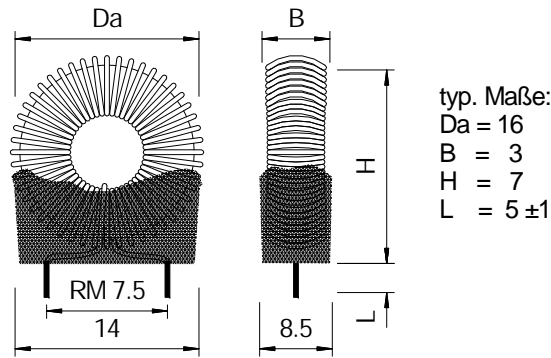

Vor dem Serieneinsatz Lötversuche durchführen!
Empf. Löttemperatur/-zeit: ca. (240-260)°C / (2-3)s.
Sockelmasse schmilzt beim Durchgang durch Lötbad und fixiert Bauteil auf der Platine.

R1305?B10

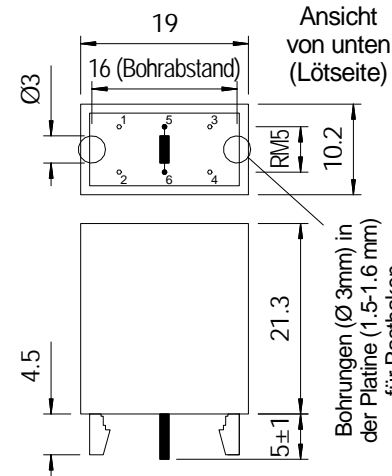

R1305?11

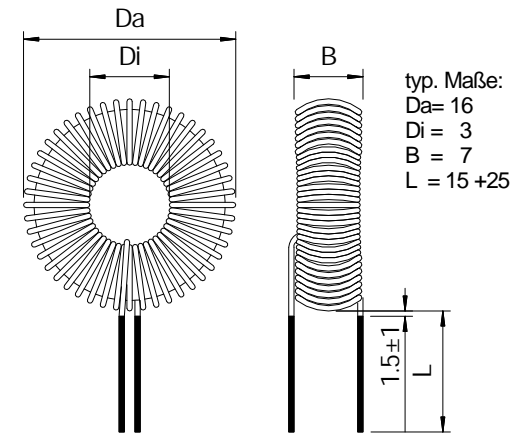

R1305?B1

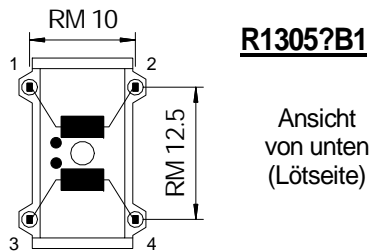

R1305?B71

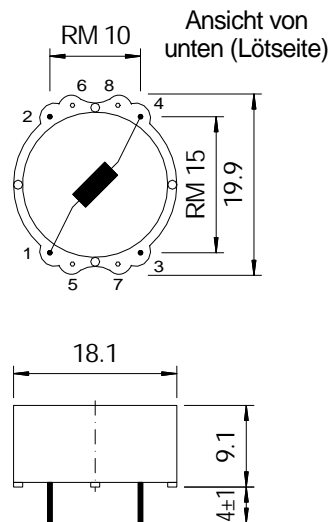

R1305?L10

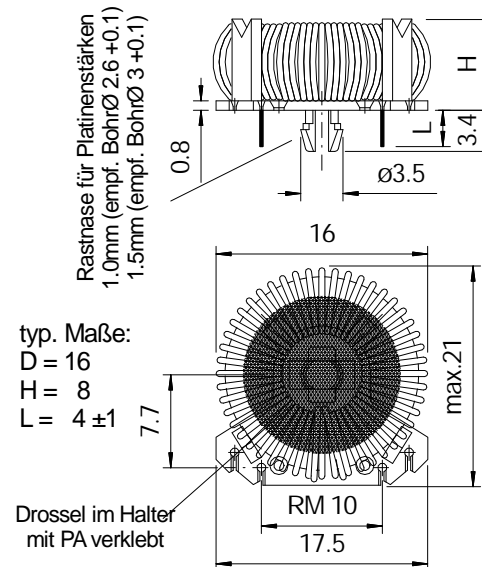

R1305?10

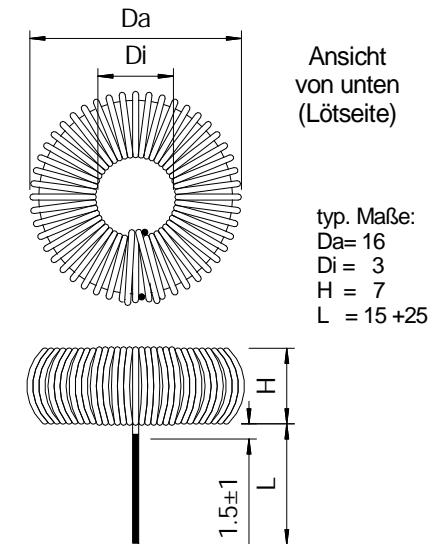

? = mögliche Materialien
A, C, D, F, K, L, M