

**R1705?S11**

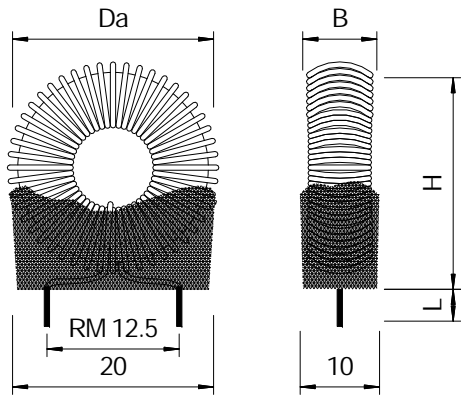

typ. Maße:  
Da = 21  
B = 8  
H = 23  
L = 5 ± 1

Vor dem Serieneinsatz Lötversuche durchführen!  
Empf. Löttemperatur/-zeit: ca. (240-260)°C / (2-3)s.  
Sockelmasse schmilzt beim Durchgang durch Lötbad und fixiert Bauteil auf der Platine.

**R1705?B2617**

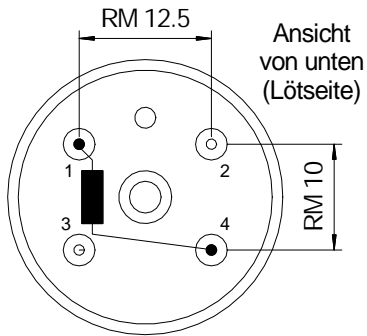

Ansicht von unten (Lötseite)

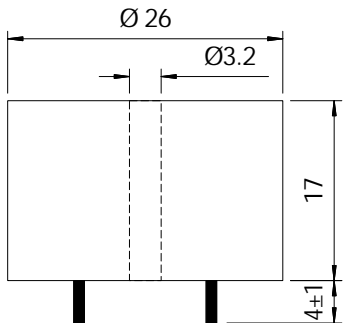

**R1705?B2615**

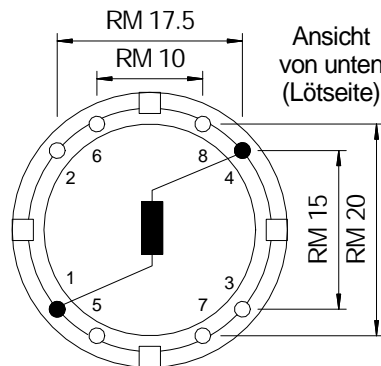

Ansicht von unten (Lötseite)

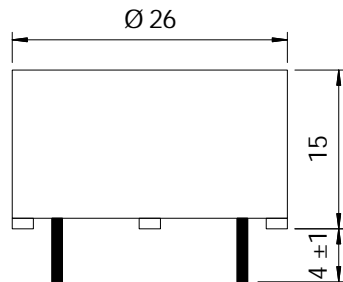

**R1705?B2**

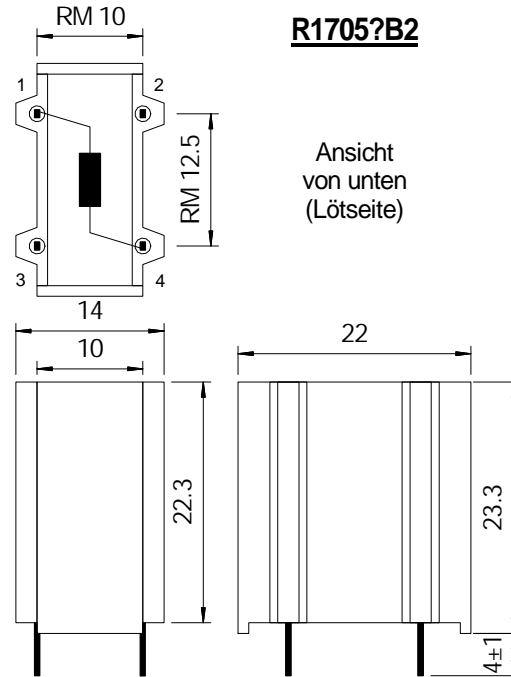

**R1705?L10**

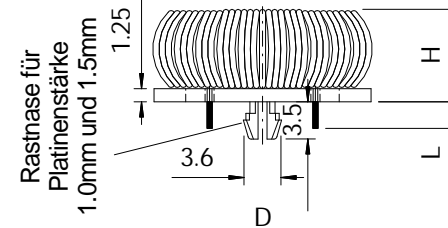

typ. Maße:  
D = 21  
H = 10  
L = 5 ± 1

Drossel im Halter mit PA verklebt

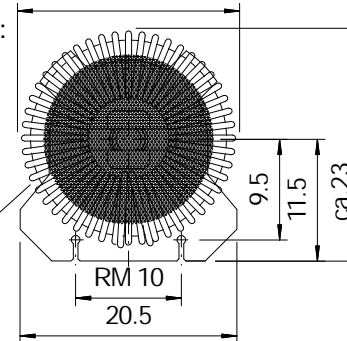

**R1705?11**

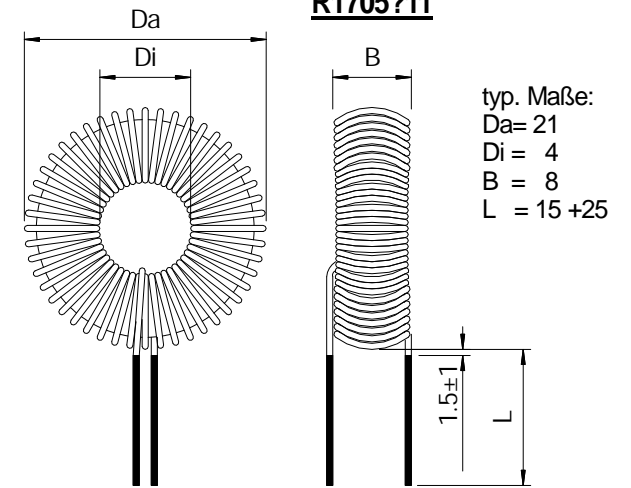

typ. Maße:  
Da= 21  
Di = 4  
B = 8  
L = 15 +25

**R1705?10**

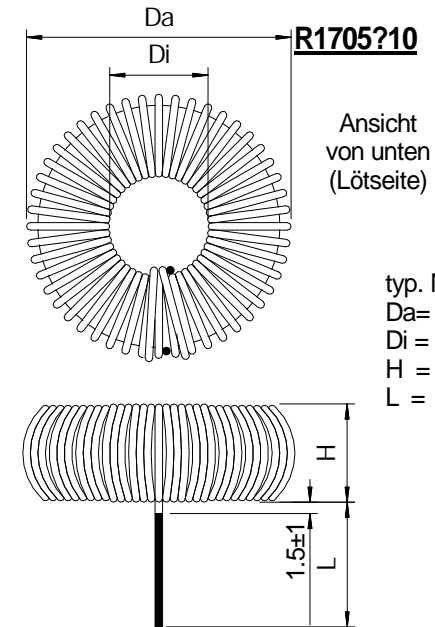

typ. Maße:  
Da= 21  
Di = 4  
H = 8  
L = 15 +25

? = mögliche Materialien  
A, C, D, F, K, L, M