

R2006?S11

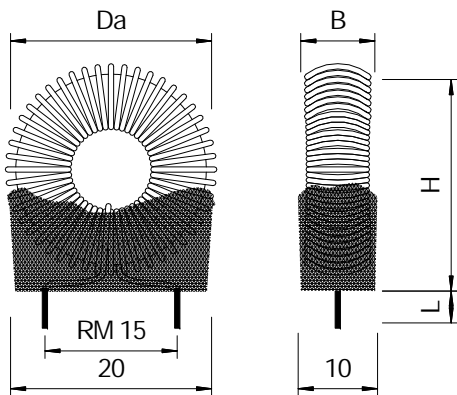

typ. Maße:
Da = 24
B = 11
H = 26
L = 5 ± 1

Vor dem Serieneinsatz Lötversuche durchführen!
Empf. Löttemperatur/-zeit: ca. (240-260)°C / (2-3)s.
Sockelmasse schmilzt beim Durchgang durch Lötbad und fixiert Bauteil auf der Platine.

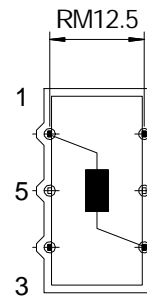

R2006?B3

Ansicht von unten (Lötseite)

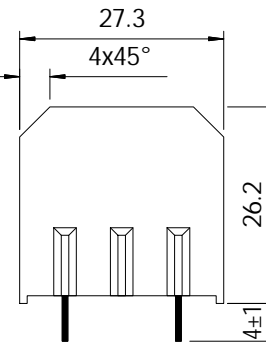

R2006?11

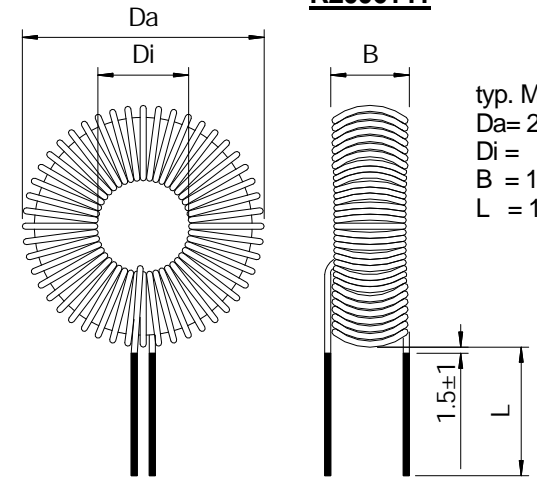

typ. Maße:
Da = 25
Di = 6
B = 11
L = 15 + 25

R2006?B30

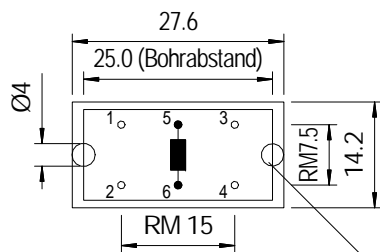

Ansicht von unten (Lötseite)

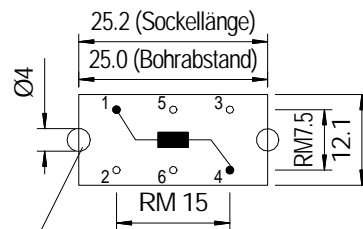

Bohrungen (Ø4mm) für Rasthaken in der Platine (1.5-1.6 mm)

typ. Maße:
D = 24
H = 25
L = 5 ± 1
Bauteilbreite: typ. ca.: 14

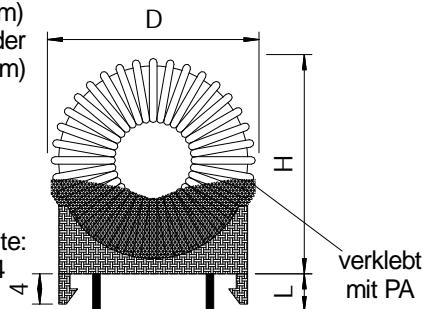

R2006?B28

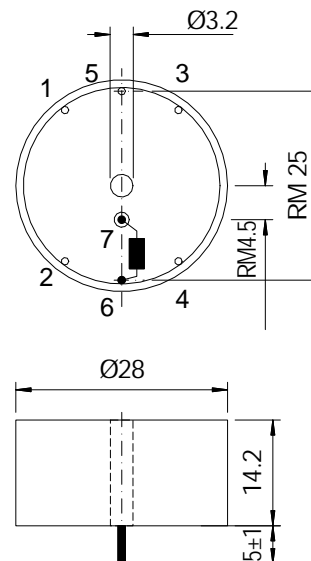

R2006?10

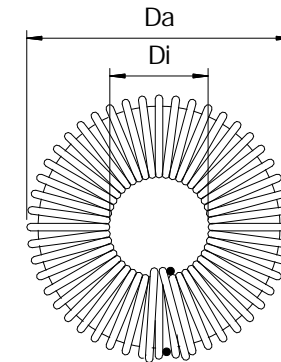

Ansicht von unten (Lötseite)

typ. Maße:
Da = 25
Di = 6
H = 11
L = 15 + 25

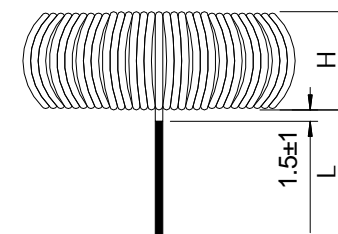

? = mögliche Materialien
A, C, D, F, K, L, M