

R3311?44

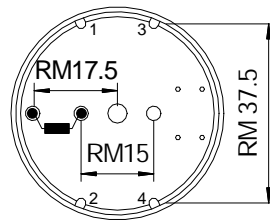

Ansicht von unten (Lötseite)

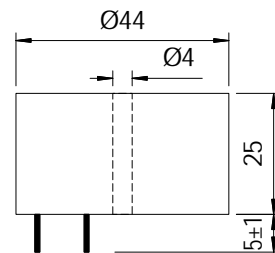

? = mögliche Materialien
A, C, **D**, F, K, L, M

R3311?11

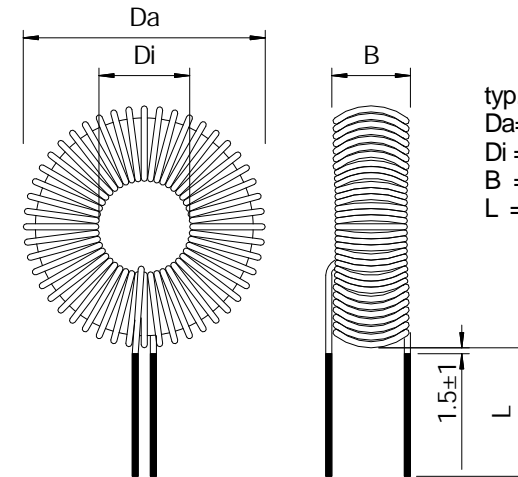

typ. Maße:
Da= 40
Di = 11
B = 18
L = 15 +25

R3311?B50

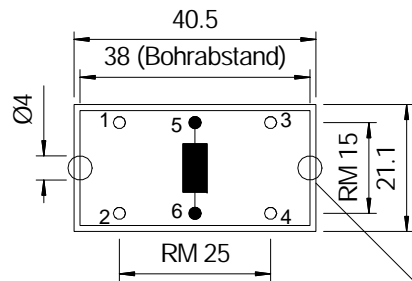

Ansicht von unten (Lötseite)

Bohrungen (Ø4.0) für Rasthaken in der Platine (1.5-1.6 mm)

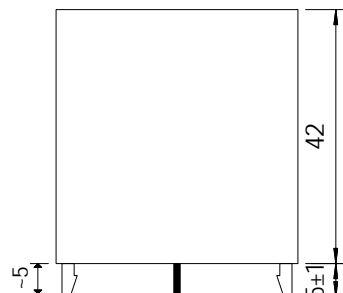

R3311?S50

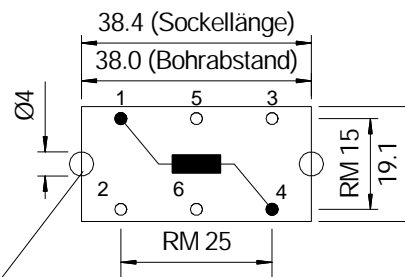

Ansicht von unten (Lötseite)

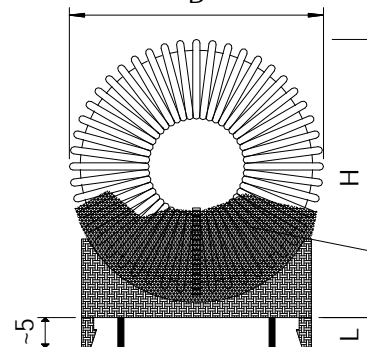

typ. Maße:
D = 40
H = 41
L = 5 ±1
Bauteilbreite:
typ. ca.: 21

R3311?10

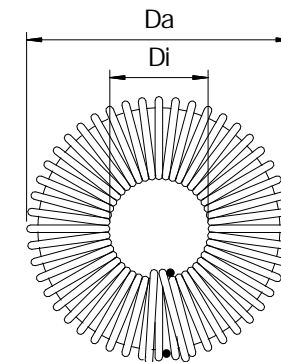

Ansicht von unten (Lötseite)

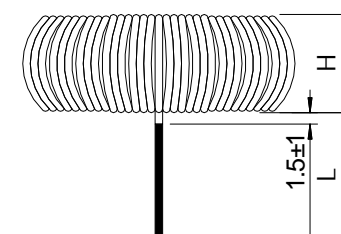

typ. Maße:
Da= 40
Di = 11
H = 18
L = 15 +25